

BLOOM TOWNSHIP SECTION 14 R12 TWP 11 MORGAN COUNTY, OH

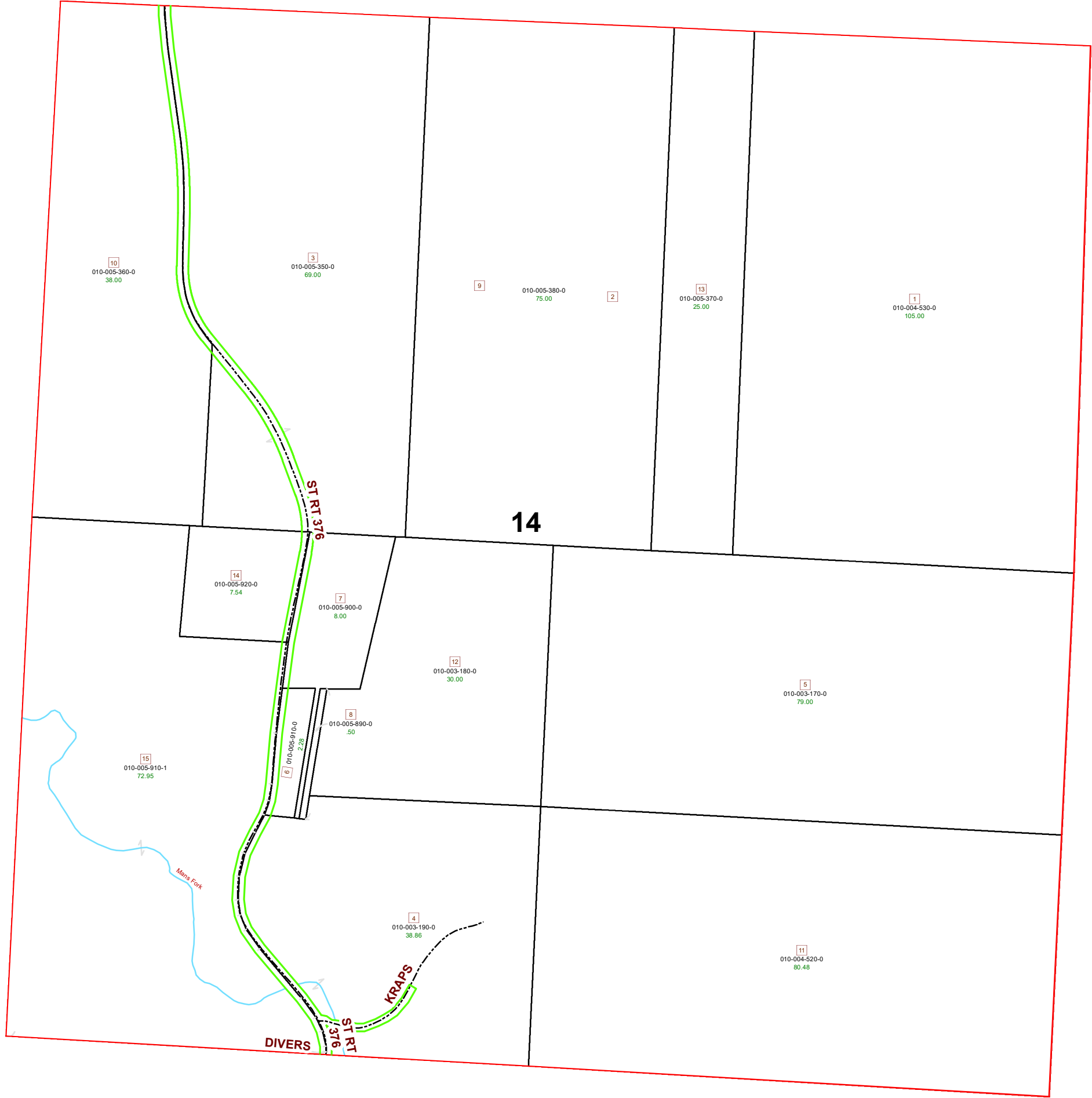

PIN	VOL	PAG	Owner	LegalDescr	Acres
010-005-890-0	OR228	550	BRAGG ADAM P & PATTY A	R12 T11 S14 SD 8 S	0.5
010-005-910-0	OR228	550	BRAGG ADAM P & PATTY A	R12 T11 S14 SD 6 S	2.283
010-005-900-0	OR228	550	BRAGG ADAM P & PATTY A	R12 T11 S14 SD 7 S	8
010-003-190-0	OR161	131	KRAPS PATRICIA ANN & CATHERINE MAE	R12 T11 S14 SD 4	38.86
010-003-170-0	OR194	551	KRAPS PATRICIA ANN & CATHERINE MAE	R12 T11 S14 SD 5	79
010-003-180-0	OR194	551	KRAPS PATRICIA ANN & CATHERINE MAE	R12 T11 S14 SD 12	30
010-005-920-0	OR233	4846	MILLER JAMES M	R12 T11 S14 SD 14	7.54
010-004-530-0	OR216	2136	OHIO FRANKLIN REALTY LLC	R12 T11 S14 SD 1 C	105
010-005-370-0	OR216	2136	ROBERTS STEPHEN D ET2AL	R12 T11 S14 SD 13	25
010-005-380-0	OR216	2136	ROBERTS STEPHEN D ET2AL	R12 T11 S14 SD 2 &	75
010-005-350-0	OR216	2136	ROBERTS STEPHEN D ET2AL	R12 T11 S14 SD 3 U	69
010-005-360-0	OR216	2136	ROBERTS STEPHEN D ET2AL	R12 T11 S14 SD 10	38
010-005-910-1	OR58	28	SPENCER GARY E & CONNIE S	R12 T11 S14 SD 15	72.956
010-004-520-0	OR137	75	STONE POINT FARMS LLC	R12 T11 S14 SD 11	80.48

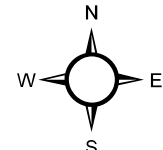

Boundaries	
	Lot
	ROW
	Roads
	County
	Section
	Hidden
	Township
	Sections
	Parcels

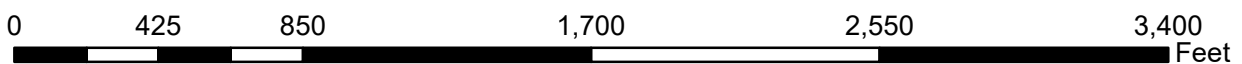

Disclaimer: The Information that these maps contains is for reference purposes only. Please bring any errors to the attention of the Engineer's Office staff. Thank You

Morgan County Engineer's Office
 Author: Marcia Wolfe
 Date: 7/17/2020